

Getting started

Quick tips about your new phone

Made with a Mission

Firefox OS was created to free you from the rules and restrictions imposed by other mobile phones and give you control over the information you store and share. It's made by Mozilla as part of our mission to put the power of the Web in everyone's hands.

Power on

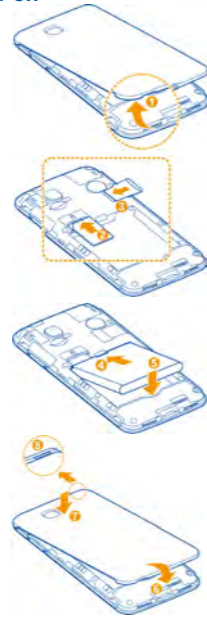

NOTE: If the battery is extremely low, you may be unable to power on the phone even when it is being charged. In this case, try again after charging the phone for at least 10 minutes. Contact customer service if you still cannot power on the phone after prolonged charging.

Unlock phone

Drag the arrow to the right to unlock your phone. If the screen is off, press the Power button.



Navigate Home

Use Search to discover content or swipe left to access all your apps.

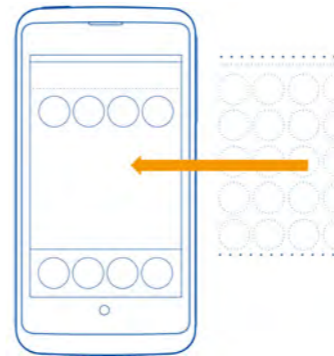

Personalize Home

Touch and hold an icon to move it within the grid or in and out of the dock. Touch the "x" to delete it. Touch Home to finish editing.

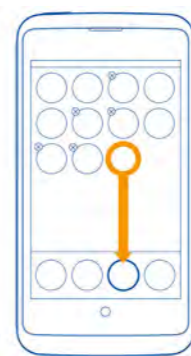

Customize wallpaper

Touch and hold the wallpaper to select or create a new one.

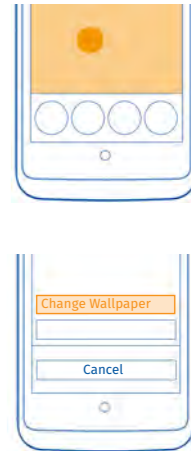

Open notifications

Swipe down from the Status Bar to see notifications, quick settings, and your mobile data use. Touch a notification to go to the related app.

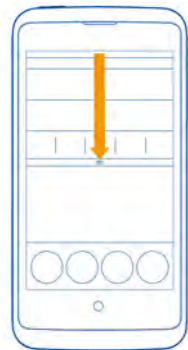

Switch applications

Touch and hold the Home button and then swipe left to see other open apps. Touch an app to switch to it.

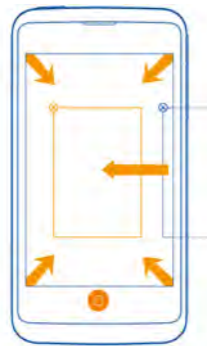

Connect to a computer

Turn on USB storage in the phone settings to transfer all your photos, music and video.

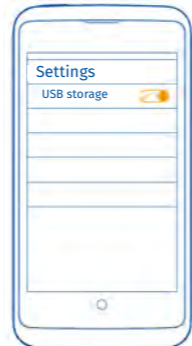

Manage mobile data

Turn your Internet connection on and off from the Settings app or quick settings.



Product Safety Information

	Do not hold phone while driving
	Do not use while re-fuelling
	When calling, keep the phone at least 15 mm from your ear
	This device may produce a bright or flashing light
	Small parts may be a choking hazard
	Do not dispose of device in a fire
	The phone may produce a loud sound
	To prevent possible hearing damage, do not listen for long periods at high volume levels
	Avoid contact with magnetic materials
	Avoid extreme temperatures
	Keep away from pacemakers and other personal medical devices
	Avoid any contact with liquids
	Switch off when instructed in hospitals and medical facilities
	Do not attempt to disassemble
	Switch off when instructed in aircrafts and airports
	Only use approved accessories
	Switch off in explosive environments

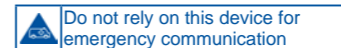

LEGAL INFORMATION

Copyright © 2014 ZTE CORPORATION.

All rights reserved.

No part of this publication may be quoted, reproduced, translated or used in any form or by any means, electronic or mechanical, including photocopying and microfilm, without the prior written permission of ZTE Corporation.

Notice

ZTE Corporation reserves the right to make modifications on print errors or update specifications in this guide without prior notice.

Disclaimer

ZTE Corporation expressly disclaims any liability for faults and damages caused by unauthorized modifications of the software.

Images and screenshots used in this guide may differ from the actual product. Content in this guide may differ from the actual product or software.

We offer self-service for our smart terminal device users. Please visit ZTE official website (at <http://www.ztedevice.com>) for more information on self-service and supported product models. Information on the website takes precedence.

Trademarks

ZTE and the ZTE logos are trademarks of the ZTE Corporation.

The *Bluetooth*® trademark and logos are owned by the Bluetooth SIG, Inc. and any use of such trademarks by ZTE Corporation is under license.

microSDHC Logo is a trademark of SD-3C, LLC.

Other trademarks and trade names are the property of their respective owners.

Note for phone call:

When you make a phone call, the screen will be automatically turned off 10 seconds after the call is connected in order to prevent accidental touch on the screen.

To turn the screen back on, press the Power button.